

TECHNICAL INFORMATION

Red coil cables 12vDC 187mA continuous rating

Blue coil cables 24vDC 88mA continuous rating

GENERAL INSTALLATION INSTRUCTIONS

The cabinet lock is designed to be fitted into cabinets and lockers with both swing and sliding doors.

SIDE ENTRY OF STRIKER

(see Fig 3) – use the 11mm to set the distance from the face of the door to the first fixing hole of the lock to prevent over or under travel of the striker (see Fig 4).

FRONT ENTRY OF STRIKER

(see Fig 3) – use the 37mm to set the distance from the back mounting face of the lock to the other mounting face of the striker to prevent over or under travel as above (see Fig 4).

FIXING OF STRIKER

CONNECT POWER TO LOCK BEFORE FITTING STRIKER

The top fixing hole of the striker base is 13mm above the top fixing hole of the lock (see Fig 5). Align the striker so that the fixing holes of the base are set 15mm out from the mounting face of the lock and 13mm vertically higher than the top fixing hole of the lock (see Fig 6).

Install striker and use the 4.5mm horizontal adjustment as well as the 5mm vertical adjustment to ensure the striker locking hole aligns with the locking pin in the lock (see Fig 7).

Finally remove tape from double sided tape on the cover and press cover into lock (see Fig 5).

WARRANTY

This product is guaranteed for a period of **5 years** against defects in manufacture, workmanship or materials provided that all electrical and mechanical installation requirements are adhered to as per this instruction sheet. All third party and consequential claims are expressly excluded from this warranty.

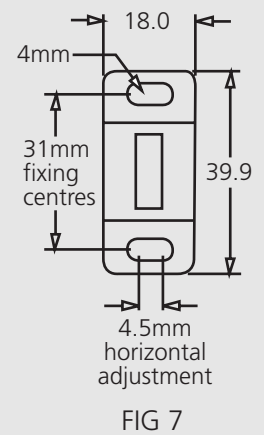
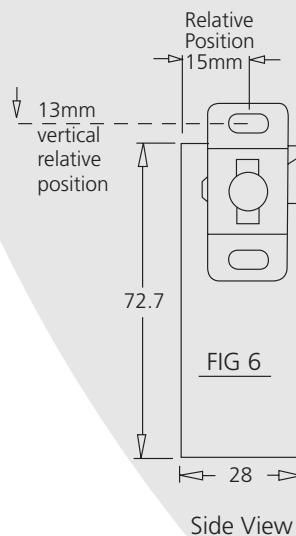
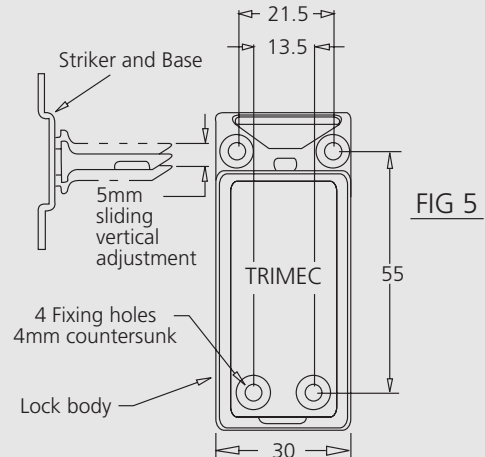
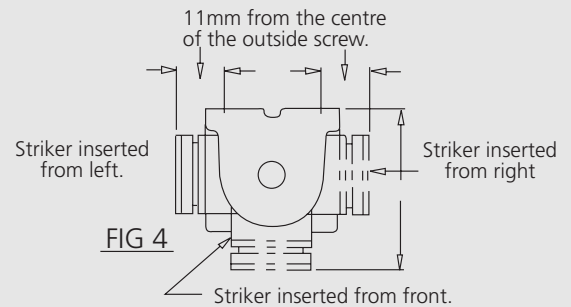
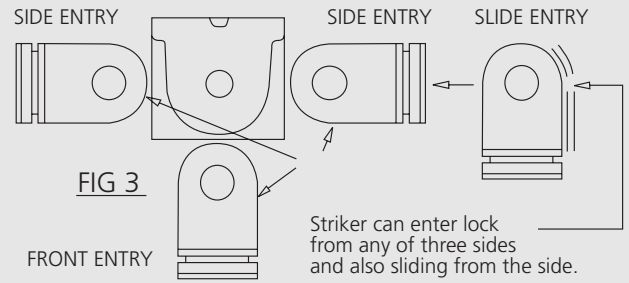

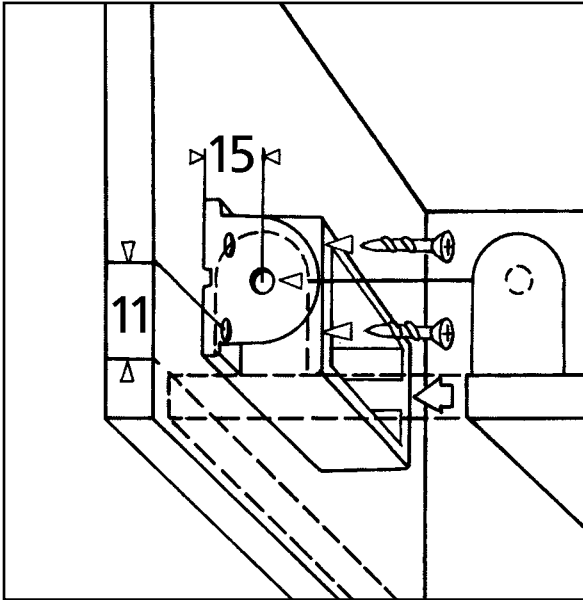

SLIDING DOORS

1 Fit door lock first

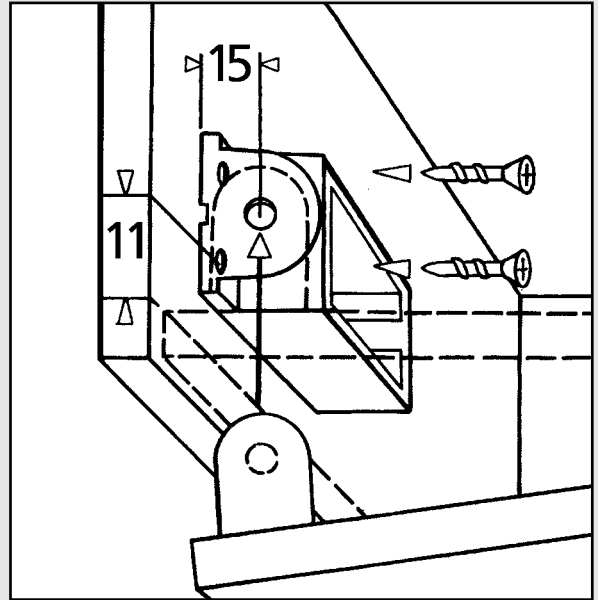

SWING DOORS

1 Fit door lock first

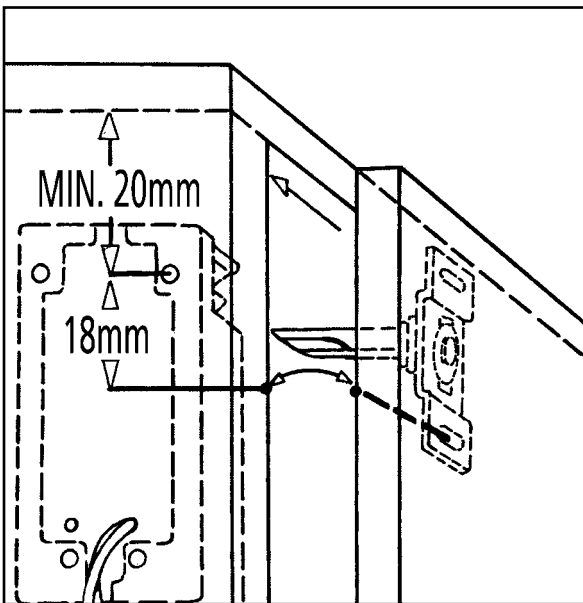

2 Fit striker second

(Transfer 18mm line to door)

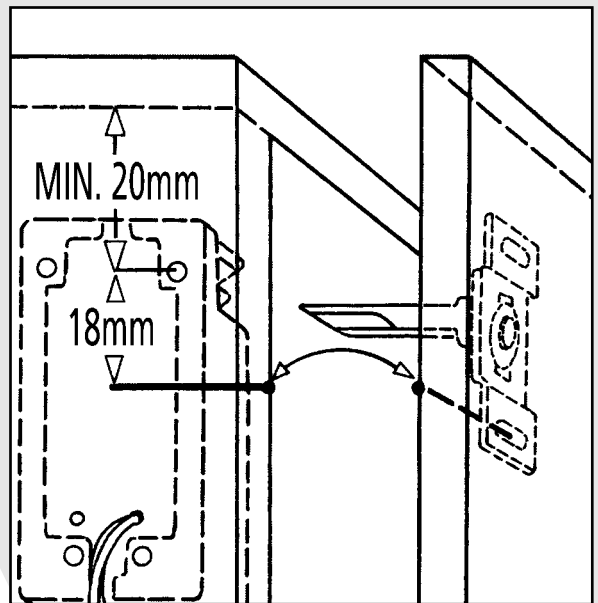

2 Fit striker second

(Transfer 18mm line to door)