

locks

Lever & Paddle Handles



Features

- Paddle handle for use with deadlatches
- Suit 44mm thick doors
- Cam plug non-handed. Reversible in the field

Functionality

Designed to be ergonomically friendly and practical. Coming complete with cam plug enables the handles to be used in conjunction with the 524510 deadlatch range of locks.



Code	Description	For use with	Finish
524591	Paddle handle complete with cam plug pull to left	4510	SAA
524592	Paddle handle complete with cam plug push to left	4510	SAA
524597	Paddle handle complete with cam plug pull to right	4510	SAA
524598	Paddle handle complete with cam plug push to right	4510	SAA

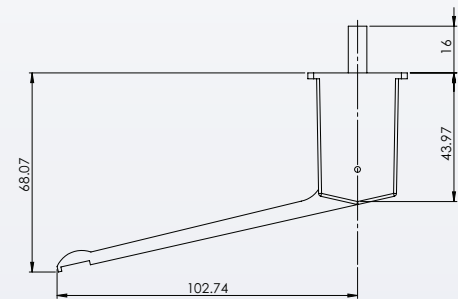
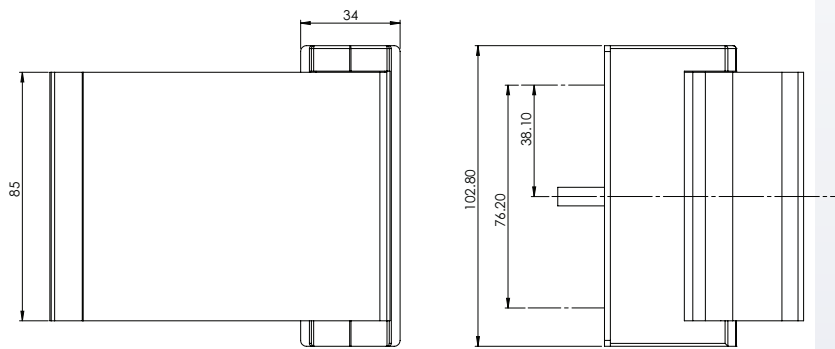

Inside of Doorway

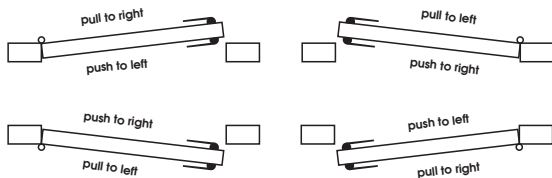

Outside of Doorway

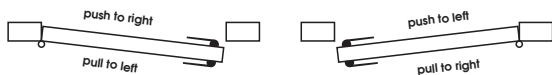

Code	Description	For use with	Finish
5245601	Lever handle complete with cam plug (RH)	4510	SAA
5245602	Lever handle complete with cam plug (LH)	4510	SAA

