

PACK CONTENTS

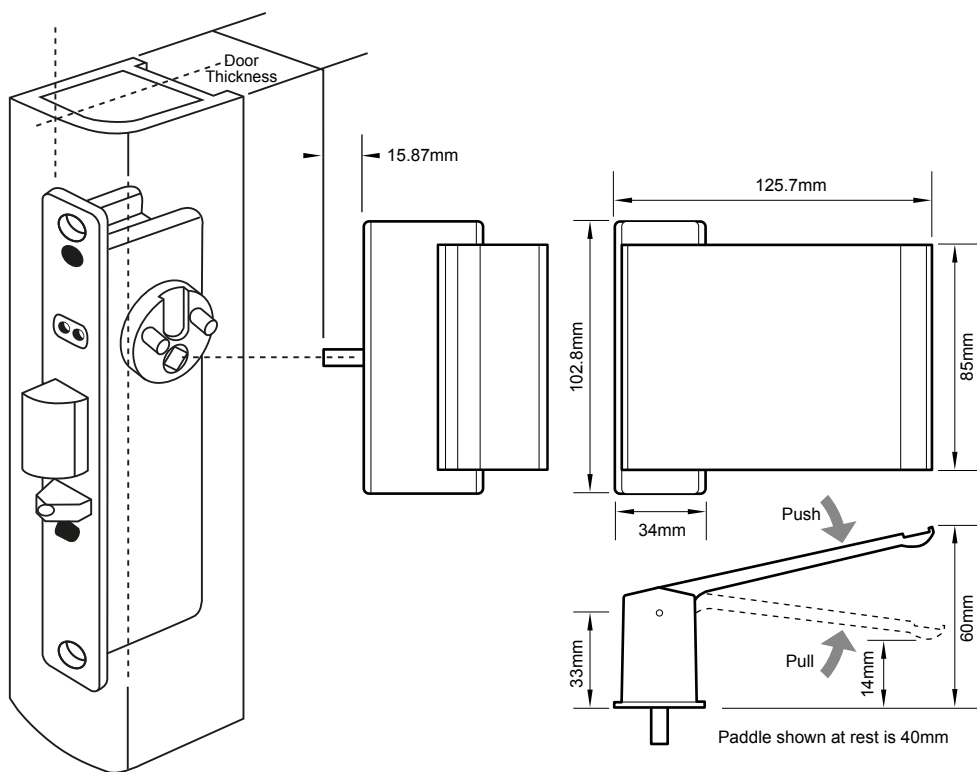

Read all instructions before starting installation

1. Stile preparation

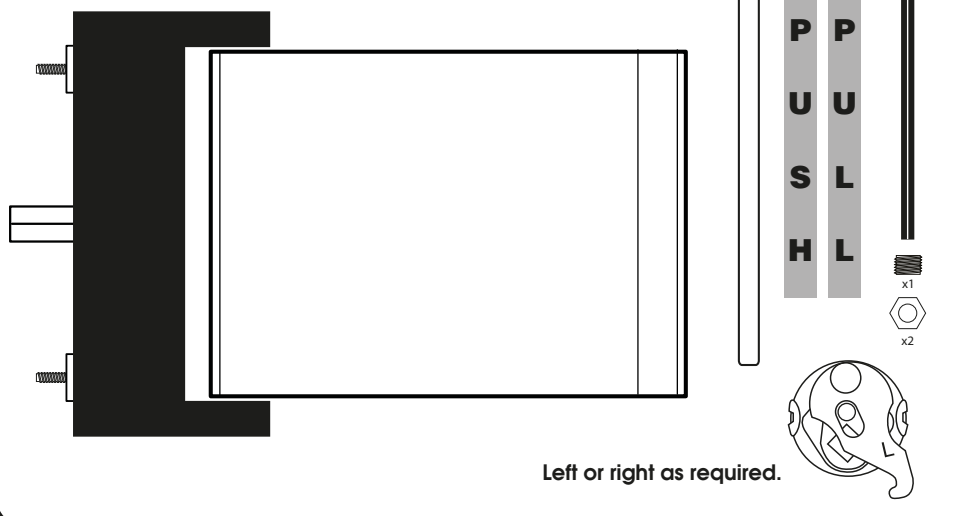
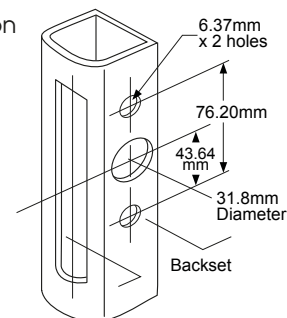

2. Install binder posts

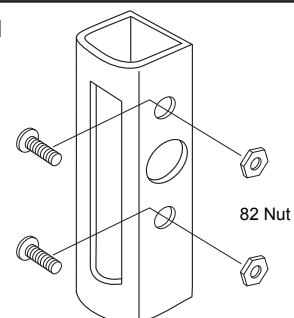

3. Install latch and cam plug

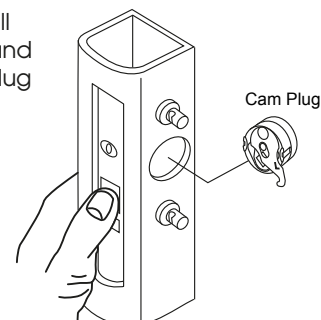

4. Install escutcheon

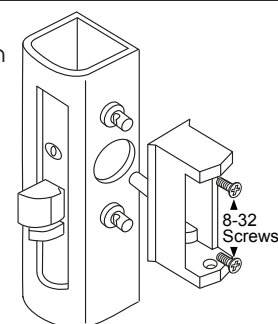

5. Install paddle

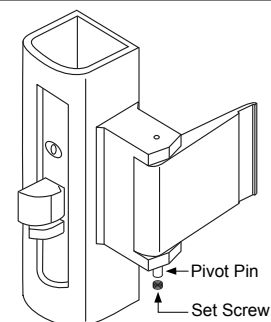

Operation	Use...
PULL - RH 	Outside of left hand reverse door or inside of right hand
PUSH - RHR 	Outside of left hand door or inside of right hand reverse
PULL - LH 	Outside of right hand reverse door or inside of left hand
PUSH - LRH 	Outside of right hand door or inside of left hand reverse

Please note: A left hand push paddle can be used as a right hand pull paddle: or a right hand push paddle can be used for a left hand pull paddle by turning over and reversing the paddle from its original mounted position.

However, it is preferable that you purchase the exact unit that you require.