

alpro

Electronic Side Load Lock

ALP210S-YD30S



The Alpro ALP210S, also known as a YD30S Cobalt-Mini, is a revolutionary low voltage motor driven electronic lock for 90° swing doors. It has been designed to secure single action doors and addresses the two biggest issues in door locking; the ability to align a misaligned door & the ability to release when requested, even with excessive load on the door. It's small footprint ensures the mini lock can be installed in most locations. The ALP210S is typically used in commercial doors and controlled by access control systems.

Suitable for

Wood, Aluminium and Glass Doors

Door Alignment

Door misalignment of up to 8mm is automatically corrected

Door Gap

Max. 6mm (1/4 inch)

Side Load Release

The door can have in excess of 600kg (1,350 lbf)

Simple Configuration

Convert from fail safe to fail secure by repositioning a single jumper

High Security

Automatic deadlocking
10,000N holding force 1,000kg (2,250lbf) 10mm thick stainless steel bolt pin
13mm bolt length

Materials

Lock/Strike Plate - Stainless Steel grade 304
Bolt - Stainless Steel 17-4 PH

Cycle Tested - 1,000,000

Electrical Specification

Input voltage from 12vDC-24vDC
Less than 40mA standby current
Reverse polarity and transient protection
Multiple attempts to lock

Dual Monitoring

Door and bolt position monitors

Initial Power Up Time & Current

11 seconds, 0.75A@12VDC, 0.4A@24VDC

Standby Current

40mA @ 12VDC, 25mA @ 24VDC

Versatile Installation

Mortice mount horizontally or vertically, on single action doors
Surface mount using the ALP210S accessories, including mounting onto glass

Physical Dimensions

160mm (L) x 30mm (W) x 47mm (D)

Certifications - UKCA & CE Marked

RoHS Directive 2011/65/EU + Amendment Directive (EU) 2015/863

Electromagnetic Compatibility (EMC) Directive 2014/30/EU
EN 61000-6-1:2019 Electromagnetic compatibility (EMC) - Part 6-1: Generic standards - Immunity for Residential, Commercial and Light-Industrial Environments

EN 61000-6-3:2021 Electromagnetic compatibility (EMC) - Part 6-3: Generic Standards - Emission Standard for Residential, Commercial and Light-Industrial Environments



3 YEAR GUARANTEE

Accessory Information

Surface mounting a lock and/or strike with the aid of the ALP210S accessories offers more flexibility in installation and makes securing glass doors possible. Dress plates are offered to give a 'clean' finish when a housing has been installed onto glass. The housing and dress plate are supplied with self-adhesive tape for instant application to glass doors and frames.

Ordering Information

Description

Cobalt-Mini Electronic Lock and Strike Plate

Code

ALP210S

Accessories

Cobalt-Mini Strike Plate – 160mm (L) x 30mm (W) x 3mm (D)

ALP213H

Cobalt-Mini Housing with tape – 164mm (L) x 34mm (W) x 56mm (D)

ALP214J

Cobalt-Mini Dress Plate with tape – 165mm (L) x 58mm (W)

ALP216J

Cobalt Fixing Tab for YD30S for use on Mortise installations only - metal extrusion

ALP208

ALP210S Electronic Lock

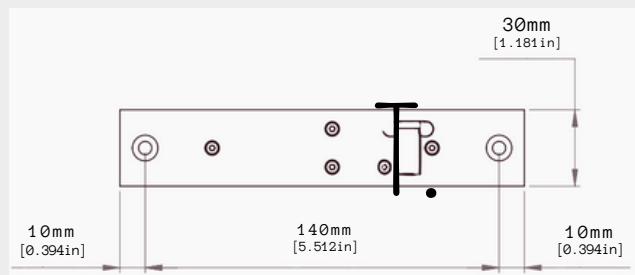
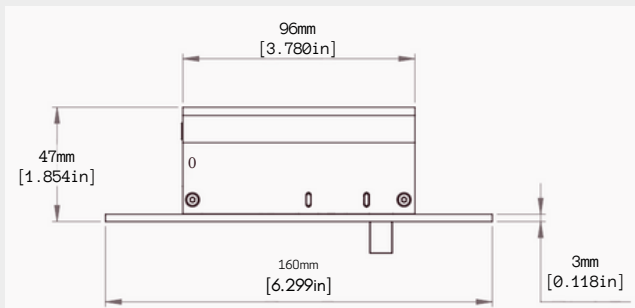

ALP213H Strike Plate (available separately)

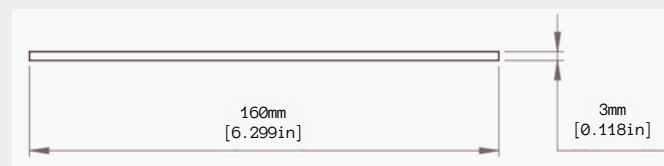
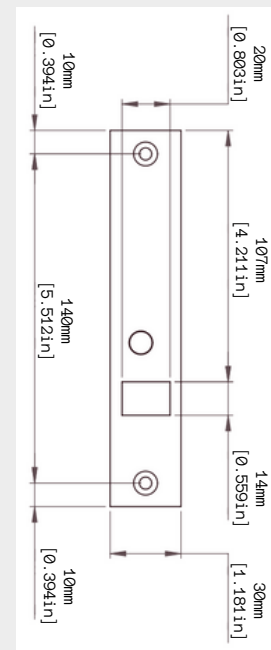
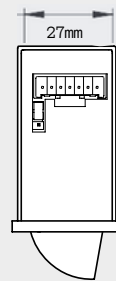

ALP214J Housing (available separately)

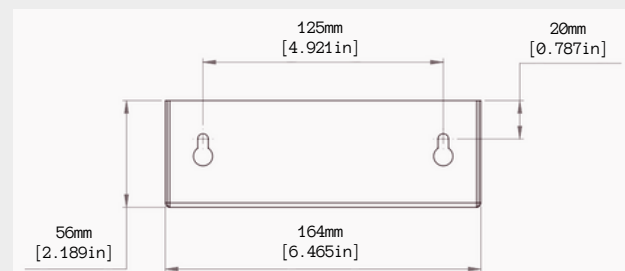
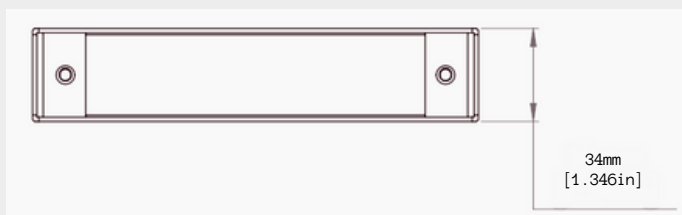

All dimensions are shown in mm.