

alpro

Modular Push Pad

Strand Push Pad Range



- The push pad emergency exit range comprises of modular components together with a push pad.
- The range offers a large degree of flexibility and can provide 1, 2 and 3 point latches (with horizontal or side entry Pullman latches) and 2 or 3 point bolts
- (with vertical pullman latches).
- Suitable for offices and buildings where people are familiar with the exits and hardware therefore a panic situation is unlikely to develop.
- Standard devices suitable for doors up to 2585mm high, for larger doors extra-long kits are available to suit doors up to 3150mm high.

Technical Drawings

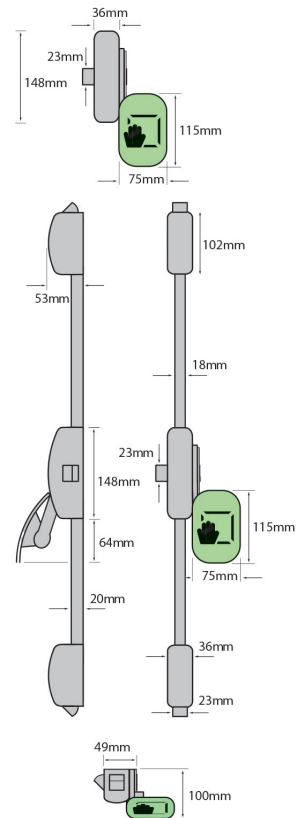

Technical drawings applicable to 83PH3520, 83PH3560320 and 83PH3580320

Application

- Supplied with striker plates for timber doors as standard.
- Strikers also available for PVC-U, Aluminium and Steel doors (Please specify when ordering).

Microswitch

- The modular cross bar range can be provided with a microswitch contained in either the operating mechanism or idler.
- If required please specify at the time of ordering stating the microswitch location (Additional cost).

Dogging facility:

Dogging should not be used on the fire/ smoke door assemblies

- The modular range is available with a dogging or hold-back facility (Additional cost).
- Can only be used on escape doors.
- If required specify when ordering.

Outside access

- Optional outside access devices are available to provide entry from the outside (Refer to Outside Access data sheet).

CE All the devices of Emergency Exit Hardware (with push pad) have been tested and certified to: EN 179:2008 (Classification: 3-7-7-B-1-4-4-2-B-A)

**UK
CA**

1 YEAR GUARANTEE

Strand Push Pad Range - Modular Push Pad

Finishes

Powder coated finishes

Silver EPS (20)

Black EPB (01)

White EPW (25)

Plated finishes

Satin Stainless Steel Plated SSSP (44)

* Polished Stainless Steel Plated PSSP (55)

* Polished Brass Plated BP (43)

* Various other RAL colours and plated finishes are available to special order. Please contact us to enquire.

83PH3520320 Single point push pad latch

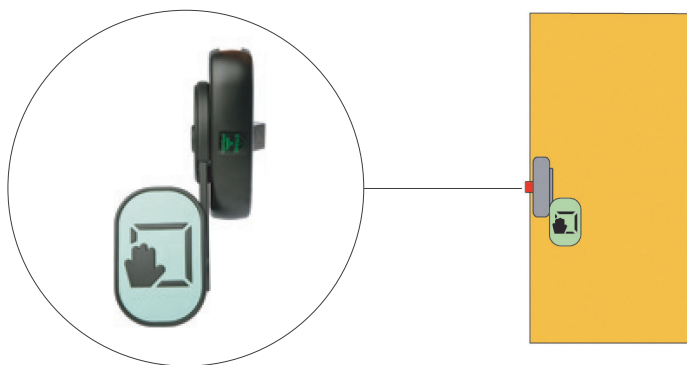

83PH3560320 Reversible 2/3-point push pad bolt

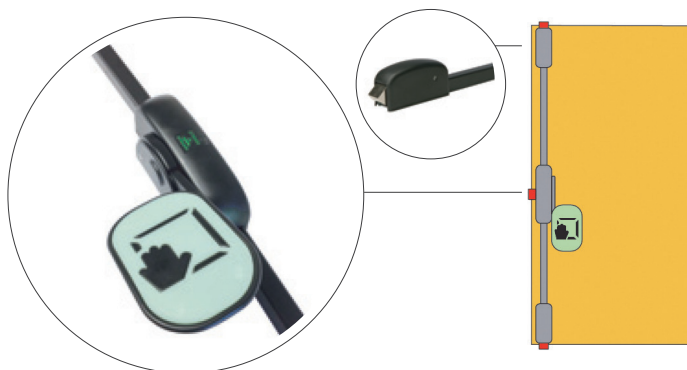

83PH3580320 Three point push pad latch



Strikers



Standard striker
(supplied with all devices)



Floor striker
(supplied with 83PH3560320)



Striker for recessed frames
(supplied separately)